

77 - 839

ORDINANCE NO. 3449

AN ORDINANCE transferring project appropriations between the Arterial Highway Development Fund and the County Road Construction Fund; reducing the East Marginal Way project budget; and adjusting project revenues; amending and revising the 1977 Capital Improvement Budget and amending Ordinance No. 2988, Section 70, Attachment No. 1, as amended.

PREAMBLE:

Ordinance No. 3310 which repealed Ordinance No. 1016 and Ordinance No. 1236 required the realignment of existing project budgets to insure that Forward Thrust commitments are contained in the Arterial Highway Development Fund, and that any projects purported to be legal pursuant to repealed ordinances be removed from the Arterial Highway Development Fund. It is the purpose of this ordinance to effect the necessary transfer of ongoing budgeted projects between funds to achieve consistency with Ordinance No. 3310; and to adjust project budgets and revenues as appropriate.

BE IT ORDAINED BY THE COUNCIL OF KING COUNTY:

SECTION 1. Appropriations in the following amounts for the projects listed below are hereby transferred from the Arterial Highway Development Fund to the County Road Construction Fund and County revenues are adjusted as identified on Attachments 1-3:

- 1. 40th Place N.E., CIP Project No. 100572 \$ 39,090
- 2. East Marginal Way, CIP Project No. 600374
- 3. S.W. 116th Street, CIP Project No. 600375 ~~(\$999,610)~~ \$125,000  
\$250,806

SECTION 2. Appropriations in the following amounts for the projects listed below are hereby transferred from the County Road Construction Fund to the Arterial Highway Development Fund and County revenues are adjusted as identified on Attachments 4-11:

- 1. Coal Creek, ETAL, CIP Project No. 400177 \$180,000  
Section 2, EE(16), Ordinance No. 3310
- 2. 15th Avenue N.E., CIP Project No. 100177 \$101,000  
Section 2, EE(41), Ordinance No. 3310
- 3. South 176th Street, CIP Project No. 800277 \$ 53,000  
Section 2, EE(53), Ordinance No. 3310
- 4. DesMoines Way @ Normandy, CIP Project No. 800378 \$110,000  
Section 2, EE(58), Ordinance No. 3310
- 5. Vaughn Hill Road, CIP Project No. 405871 \$100,000  
Section 2, EE(84), Ordinance No. 3310
- 6. 124th Avenue N.E., CIP Project No. 200477 \$ 57,000  
Section 2, EE(96), Ordinance No. 3310
- 7. 132nd Ave. S.E. @ S.E. 256th Street, CIP Project No. 700377 \$ 45,000  
Section 2, EE(98), Ordinance No. 3310
- 8. Peasley Canyon Road, CIP Project No. 800973 \$139,000  
Section 2, EE(119), Ordinance No. 3310

SECTION 3. A reduction of appropriation in the amount of \$47,704 from the unencumbered fund balance of the County Road Fund to CIP Project 99977 "Transfer to Fund 386" is hereby adopted and approved as reflected in the revenue changes associated with Sections 1 and 2 of this ordinance.

SECTION 4. Ordinance No. 2988, Section 70, as amended, is hereby amended to read as follows:

County Road Construction Fund	((\$3,267,000))	<u>\$2,896,896</u>
Arterial Highway Development Fund	((\$2,142,241))	<u>\$1,637,735</u>
County Road (CIP only)	((\$3,581,521))	<u>\$3,533,817</u>

SECTION 5. The Project Information sheets attached hereto are adopted to amend and revise the King County 1977 Capital Improvement Budget; amending Ordinance No. 2988, Section 70, Attachment No. 1, as amended.

INTRODUCED AND READ for the first time this 12<sup>th</sup> day of September, 1977.

PASSED this 17<sup>th</sup> day of October, 1977.

KING COUNTY COUNCIL  
KING COUNTY, WASHINGTON

Mike Lowry  
Chairman

ATTEST:

Dorothy M. Owens DEPUTY  
Clerk of the Council

APPROVED this 19<sup>th</sup> day of October, 1977.

[Signature]  
County Executive

1  
2  
3  
4  
5  
6  
7  
8  
9  
10  
11  
12  
13  
14  
15  
16  
17  
18  
19  
20  
21  
22  
23  
24  
25  
26  
27  
28  
29  
30  
31  
32  
33

Project: 100572 40th Place Northeast — Et al

Posting Date: AUGUST 1977

Description:

Council District  
CIP Planning

Location: King/Snohomish County Line south to Lake Forest Park City Limits

Work Scope: Add drainage and pedestrian facilities along 40th Place N.E. and on 35th Avenue N.E., northerly from Lake Forest Park City limits. Minor construction on 37th Place N.E. to meet with the Mountlake Terrace Road "Cedar Way South".

Objective: Increase pedestrian safety, vehicular safety, and to correct drainage problems along the roadways mentioned. To conform with previous construction done by the cities of Lake Forest Park and Mountlake Terrace.

Cost Data:

Original Cost Estimate 1971 \$322,574  
Current Cost Estimate (1977) \$352,000

Status:

Plan development to start 1977.

Project Data:

FUND 00000 3860 COUNTY ROAD CONSTRUCTION  
DEPT 0735 ROADS-ARTERIAL HIGHWAY  
FUNCTION 54100 ROAD & STREET CONSTRUCTION  
SERVICE 54153 ARTERIAL-SECONDARY  
PROGRAM 54173 DISCRETE PROJECTS

AGENCY

DEFIN

PRIOR YRS  
EXPENDITURES

FY19  
BLD.

1. DESIGN, PRELIM ENGINEERING
2. ACQUISITION OR RIGHT-OF-WAY
3. CONSTRUCTION

....ANNUAL PROJECT TOTAL 2,910 39  
....78-83 PROJECT COST 310,000  
....TOTAL PROJECT COST 352,000

REVENUE SOURCES

33141 (A) F A M ROAD GRANT  
37203 (A) CONTRIBN-COUNTY ROADS  
....ANNUAL REVENUE TOTAL 2,910 39  
....TOTAL REVENUE 352,000

72 - 839

3119

Project: 600374 East Marginal Way — Signals

Printing Date AUGUST 1977

Description: Council District: No. 8  
CIP Planning Area: West Central

Location: Seattle City limits to Boeing Access Road.  
Work Scope: Add to or remove existing traffic control facilities as required to reduce annual maintenance cost.  
Objective: To improve traffic flow from industrial parking lots and reduce accidents on this major arterial. Efforts are being coordinated with adjacent industrial firms.  
Length: Traffic Signals

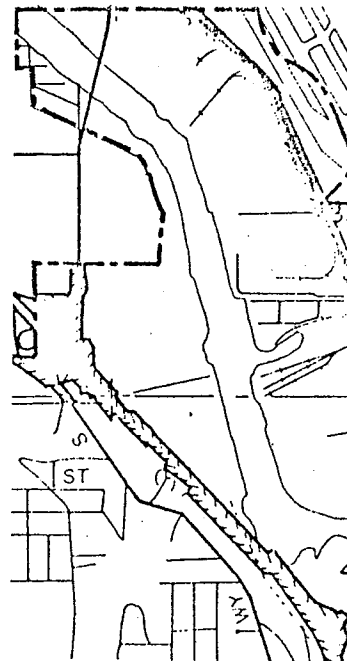

Cost Data: Status:  
Original Cost Estimate 1972 \$630,000  
Current Cost Estimate 1975 \$1,096,500  
Design consultant in process of developing design report.

Project Data: AGENCY 70 RESPONSIBLE ORG 1697 ARTERIAL  
000003860 COUNTY ROAD CONSTRUCTION DEPARTMENT PRIORITY REQUEST I  
000003860 ARTERIAL HIGHWAY LOCATION - SEATTLE C/L TO S BOEING  
DEPT 0735 ROADS-ARTERIAL HIGHWAY CIP PLANNING AREA - 004 WEST CENTRAL  
FUNCTION 54100 ROAD & STREET CONSTRUCTION COUNCIL DISTRICT - 008  
SERVICE 54151 ARTERIAL-MAJOR  
PROGRAM 54171 DISCRETE PROJECTS

OPTION	PRIOR YRS EXPENDITURES	EXISTING BUDGET	1978 REQUEST	PROGRAM PROJECTION IN ***** 1979 1980
1. DESIGN, PRELIM ENGINEERING		125,000	55,200	
2. CONSTRUCTION		930,000	930,000	
....ANNUAL PROJECT TOTAL	389	999,610	985,200	
....78-83 PROJECT COST		125,000		
....TOTAL PROJECT COST		125,000		
REVENUE SOURCES				
33141 (A) F A M ROAD GRANT		100,000	550,000	
34950 (A) SEATTLE COOPERATION FUNDS		362,610	245,610	
37204 (A) CENTRAL-COUNTY ROADS		25,000	25,000	
....ANNUAL REVENUE TOTAL	389	987,610	820,610	
....TOTAL REVENUE		125,000		
		( 125,000 - AVAILABLE		- PENDING )

Project: 600375 Southwest 116th Street

Description:

Council District: No. 7  
CIP Planning Area: West Central

Location: 26th Ave. S.W. to Ambaum Boulevard

Work Scope: Improve existing facilities and bring up to current standards of roadway section of this classification. May include curb and gutter, sidewalk.

Objectives: Increase the efficiency and safety for both vehicular and pedestrian type traffic within adjoining neighborhoods.

Length: 0.60 Mile

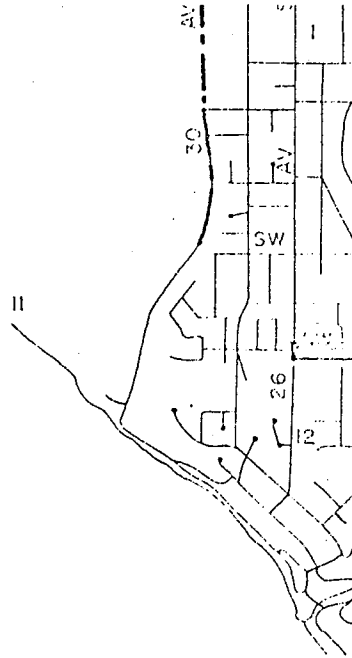

Cost Data:

Original Cost Estimate 1972 \$252,000

Status:

Design started in 1975 and is continuing.

Project Data:

00000 3060 COUNTY ROAD CONSTRUCTION	AGENCY 70	RESPONSIBLE OGC 1697	ARTERIAL
<del>00000 3060 COUNTY ROAD CONSTRUCTION</del>		DEPARTMENT PRIORITY REQUEST 45	
0735 ROADS-ARTERIAL HIGHWAY		LOCATION - AMBAUM BLVD TO 26TH AVE	
54100 ROAD & STREET CONSTRUCTION		CIP PLANNING AREA - 004	WEST CENTRAL
54152 ARTERIAL COLLECTOR		COUNCIL DISTRICT - 007	
54172 DISCRETE PROJECTS			

	PRIOR YRS EXPENDITURES	EXISTING BUDGET	1978 REQUEST	PROGRAM PROJECTION IN ***** 1979 1980
1. DESIGN, PRELIM ENGINEERING		9,037	-	
2. ACQUISITION OF RIGHT-OF-WAY		50,001		
3. CONSTRUCTION		191,768		
....ANNUAL PROJECT TOTAL	38,252	250,806		
....78-88 PROJECT COST				
....TOTAL PROJECT COST	289,058			
<hr/>				
REVENUE SOURCES				
03141 (A) F.A.M. ROAD GRANT		138,000		
<del>03141 (A) F.A.M. ROAD GRANT</del>		<del>112,806</del>	-112,806	
07001 (A) CONTRIBN-COUNTY ROADS		112,806	112,806	
....ANNUAL REVENUE TOTAL	38,252	250,806		
....TOTAL REVENUE	289,058	( 250,806 - AVAILABLE		- PENDING )

Description: Council District: No. 6  
CIP Planning Area: Central

Location: Interstate 405 to Bellevue City Limits

Work Scope: Develop pathways, place new traffic signal on Coal Creek Parkway, revise existing signals at 128th Ave. SE and Newport Way Intersections.

Objective: Provide pedestrian facilities and separation from motorized vehicles. Modernize traffic control devices and improve transit access.

Length: Does not apply.

This project provides for Section 2, EE (16), Ordinance 3310.

Cost Data: Status:  
Original Cost Estimate (1976) \$180,000 Construction planned for late 1977 start.

Project Data:

FUND 06000 3300 ARTERIAL HIGHWAY  
DEPT 0737 ROADS-COUNTY ROADS CONST  
FUNCTION 54100 ROAD & STREET CONSTRUCTN  
SERVICE 54157 SPECIALIZED PROJECTS  
PROGRAM 54177 DISCRETE PROJECTS

DEPARTMENT PRIORITY REQUEST 1  
LOCATION - TRAFFIC SIGNALS  
CIP PLANNING AREA - 008 CENTRAL  
COUNCIL DISTRICT - 006

OPTION	PRGR YRS EXPENDITURES	EXISTING BUDGET	1978 REQUEST	PROGRAM PROJECTION I ***** 1979 1980
1. DESIGN, PRELIM ENGINEERING		36,000		
3. CONSTRUCTION		144,000		
....ANNUAL PROJECT TOTAL		180,000		
....78-83 PROJECT COST				
....TOTAL PROJECT COST	180,000			
REVENUE SOURCES				
33141 (A) F A M ROAD GRANT		144,000		
33002 (A) --GENERAL-COUNTY-ROADS		36,000		
30110 (A) BEG. UNENCUMBERED FUND BALANCE		36,000		
....ANNUAL REVENUE TOTAL		180,000		
....TOTAL REVENUE	180,000		( 180,000 - AVAILABLE	- PENDING )

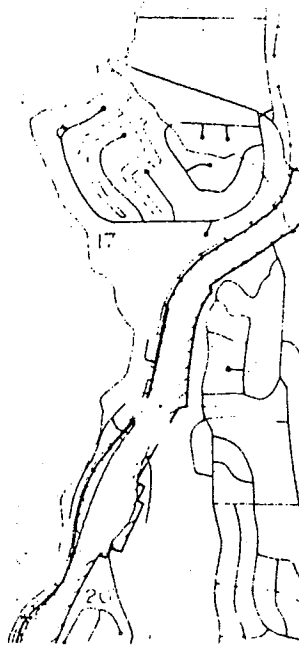

Project: 100177 15th Avenue N.E.

Project Date: AUGUST 1977

Description:

Council District: No. 1  
CIP Planning Area: Shoreline

Location: Northeast 195th Street to Northeast 205th Street

Work Scope: Grade and pave roadway surface, install required drainage related items together with moderate landscape finish work.

Objective: Eliminate current operating speed/volume-capacity deficiency as defined within the "1976 Arterial Highway Priority Array" for major arterials.

Length: 0.62 Mile

This project provides for Section 2 EE (41), Ordinance 3310.

Cost Data:

Original Cost Estimate 1976 \$ 400,000

Status:

Preliminary design work starting mid-1977.

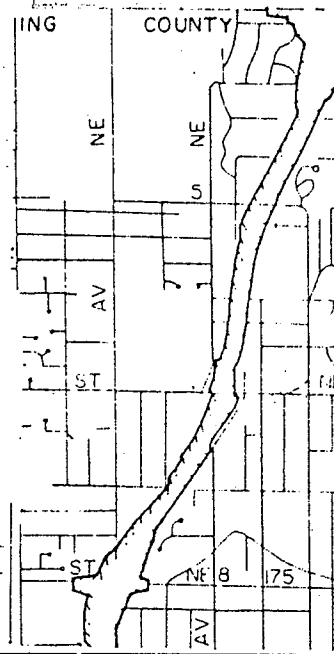

Project Data:

FUND 00000 3360 ARTERIAL HIGHWAY  
 DEPT 0737 ROADS-COUNTY ROADS CONST  
 FUNCTION 54100 ROAD & STREET CONSTRUCTION  
 SERVICE 54151 ARTERIAL-MAJOR  
 PROGRAM 54171 DISCRETE PROJECTS

DEPARTMENT PRIORITY REQUEST 4  
 LOCATION - NE 195 ST TO NE 205TH  
 CIP PLANNING AREA - 002 SHORELINE  
 COUNCIL DISTRICT - 001

ACTION	PRIOR YRS EXPENDITURES	EXISTING BUDGET	1978 REQUEST	PROGRAM PROJECTION IN	
				1979	1980
1. DESIGN, PRELIM ENGINEERING		75,000			
2. ACQUISITION OF RIGHT-OF-WAY		26,000			
3. CONSTRUCTION					319
....ANNUAL PROJECT TOTAL		101,000			319
....78-83 PROJECT COST	319,000				
....TOTAL PROJECT COST	420,000				
REVENUE SOURCES					
33141 (A) F & M ROAD GRANT		66,000			207
<del>33141 (A) F &amp; M ROAD GRANT</del>		<del>35,000</del>			<del>112</del>
30110 (A) BEG. UNENCUMBERED FUND BALANCE		35,000			112
....ANNUAL REVENUE TOTAL		101,000			319
....TOTAL REVENUE	420,000				
		( 420,000 - AVAILABLE			- PENDING )

Description:

Council District:  
CIP Planning Area:

A cash transfer of County Road Fund balance contained in the County Road Fund No. 00103 to the newly established County Road Construction Fund No. 00386. This transfer will provide the County portion of funding required for all the recommended 1977 "New Start" Road Projects budgeted in the County Road Construction Fund No. 00386.

Cost Data:

Status:

Project Data:

FUND	000001030	COUNTY ROAD	AGENCY	RESPONSIBLE ORG	1694 ROADS - CIP
DEPT	0734	ROADS - CONSTRUCTION		DEPARTMENT PRIORITY REQUEST	
FUNCTION	54100	ROAD & STREET CONSTRUCTION		LOCATION	COUNTYWIDE
SERVICE	54157	SPECIALIZED PROJECTS		CIP PLANNING AREA	COUNTYWIDE
PROGRAM	54184	PROJECT CONTINGENCY		COUNCIL DISTRICT	COUNTYWIDE
* * * * * CAPITAL IMPROVEMENTS * * * * *					
OPTION		PRIOR YEAR EXPENDITURES	EXISTING BUDGET	1977 REQUEST	* * * PROGRAM PROJECTION IN THOUSANDS OF DOLLARS 1978      1979      1980      1981

- 1. DESIGN, PRELIM ENG.
- 2. ACQUISITION OR R/WAY
- 3. CONSTRUCTION
- 4. EQUIP & FURNISHINGS
- 5. CONTINGENCY
- 6. ARTISTIC FURNISHINGS

\$1,065,000      \$1,017,796

EXPENDITURE TOTAL \$1,017,796

REVENUES

51121 (A)	REAL PROPERTY TAX DIV. TO ROADS	988,500	988,500
50110 (A)	BEG. UNENCUMBERED FUND BALANCE	77,000-	29,296

REVENUE TOTAL \$1,065,000 \$1,017,796

TOTAL PROJECT COST ESTIMATE \$ 1,017,796

TOTAL REVENUE - AVAILIABLE \$ 1,017,796 PENDING \$



Description:

Council District: No. 9  
 C/P Planning Area: Federal Way

Location: Military Road S. to W. Valley Road.

Work Type: Grade, shape and overlay and provide uphill passing lane where required. Improve open ditch drainage.

Objective: Increase safety, efficiency and convenience of traffic movements along arterial, that connects the population and the shopping centers of Federal Way with Auburn.

Length: 1.75 miles.

This project provides for Section 2 EL (119), Ordinance 3310.

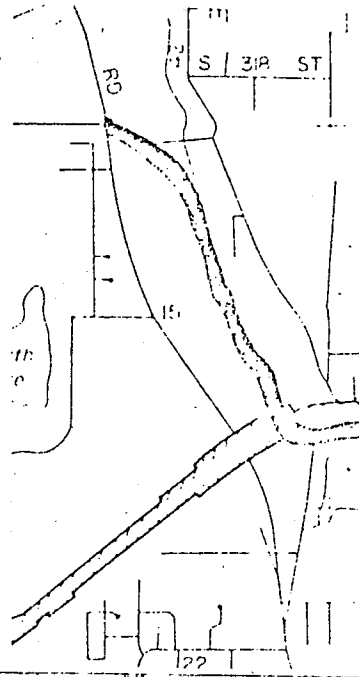

Cost Data:

Original Cost Estimate (1971) \$466,095  
 Current Cost Estimate (1976) 770,000

Status:

Preliminary engineering to start late 1977.

Project Data:

AGENCY	70	RESPONSIBLE CPG	1695	COUNTY	
PROJECT	0717	DEPARTMENT	PRIORITY	REQUEST	26
FUNCTION	54100	ROAD & STREET CONSTRUCTION			
SERVICE	54152	ARTERIAL-SECONDARY			
PROGRAM	54172	DISCRETE PROJECTS			
		LOCATION -	MILITARY RD S TO W VALLEY		
		C/P PLANNING AREA -	009	FEDERAL	
		COUNCIL DISTRICT -	009		

SECTION	PRIOR YRS EXPENDITURES	EXISTING BUDGET	1977 REQUEST	PROGRAM PROJECTION IN	
				1979	1980
1. DESIGN, PRELIM ENGINEERING		139,000			
2. ACQUISITION OF RIGHT-OF-WAY				301	
3. CONSTRUCTION					295
.....ANNUAL PROJECT TOTAL		139,000		301	295
.....78-83 PROJECT COST	596,000				
.....TOTAL PROJECT COST	735,000				
<b>AVAILABLE REVENUE</b>					
7110 (A) F.A.M. ROAD GRANT		90,350		205	206
7110 (A) BIG. UNENCUMBERED FUND BALANCE		48,650		96	89
.....ANNUAL REVENUE TOTAL		139,000		301	295
.....TOTAL REVENUE	735,000				
		( 735,000 - AVAILABLE			- READING )

Description:

Council District: No. 9  
CIP Planning Area: Kent-Auburn

Location: Intersection of 132nd Ave. S.E. @ S.E. 256th St.

Work Scope: Install traffic control device with pedestrian crossing control.

Objective: Improve pedestrian facilities.

Length: Intersection

This project provides for Section 2, EE (98), Ordinance 3310.

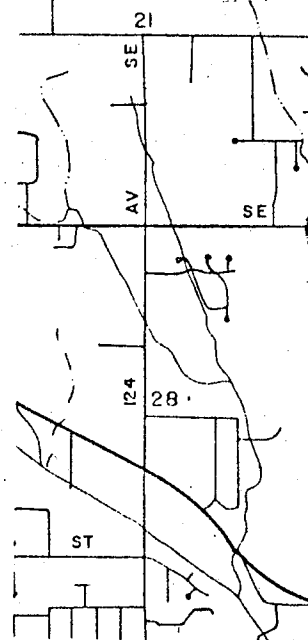

Cost Data:

Original Cost Estimate (1976) \$ 45,000

Status:

To be constructed during 1977.

Project Data:

FUND 00000 3360 ARTERIAL HIGHWAY  
~~00000 3360 COUNTY ROAD CONSTRUCTION~~  
DEPT 0737 ROADS-COUNTY ROADS CONST  
FUNCTION 54100 ROAD & STREET CONSTRUCTION  
SERVICE 54157 SPECIALIZED PROJECTS  
PROGRAM 54177 DISCRETE PROJECTS

AGENCY 70

RESPONSIBLE ORG 1695 COUNTY  
DEPARTMENT PRIORITY REQUEST  
LOCATION - INTERSECTION SIGNAL  
CIP PLANNING AREA - 009 KENT  
COUNCIL DISTRICT - 009

OPTION	PRIOR YRS EXPENDITURES	EXISTING BUDGET	1978 REQUEST	PROGRAM PROJECTION ***** 1979 1980
1. DESIGN, PRELIM ENGINEERING		9,000		
2. CONSTRUCTION		36,000		
....ANNUAL PROJECT TOTAL		45,000		
....78-83 PROJECT COST				
....TOTAL PROJECT COST	45,000			
-----				
REVENUE SOURCES				
33141 (A) F A M ROAD GRANT		36,000		
<del>37203 (A) COUNTY ROADS</del>		<del>9,000</del>		
30110 (A) BEG. UNENCUMBERED FUND BALANCE		9,000		
....ANNUAL REVENUE TOTAL		45,000		
....TOTAL REVENUE	45,000			

( 45,000 - AVAILABLE - FENCING

Description:

Council District: No. 3  
CIP Planning Area: Northshore

Location: Northeast 132nd Street to Northeast 160th Street

Work Scope: Construct bicycle and pedestrian facilities.

Objective: Provide motorized vehicle and non-motorized traffic separation and safety.

Length: 1.75 Mile

This project provides for Section 2 EE (96), Ordinance 3310.

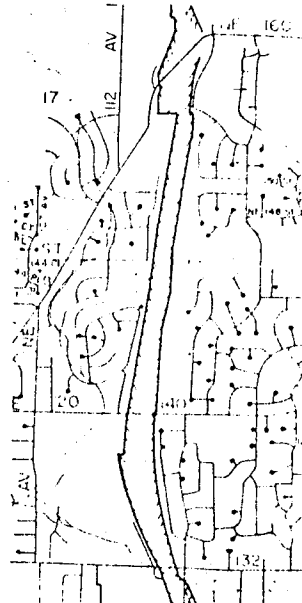

Cost Data:

Status:

Original Cost Estimate (1976) \$125,000

Programmed for start in 1977.

Project Data:

00000 3360 ARTERIAL HIGHWAY  
 00000 0000 ROADWAY CONSTRUCTION  
 DEPT 0727 ROADS-COUNTY ROADS CONST  
 FUNCTION 54100 ROAD & STREET CONSTRUCTION  
 SERVICE 54153 ARTERIAL-SECONDARY  
 PROGRAM 54173 DISCRETE PROJECTS

AGENCY 70

RESPONSIBLE CAG 1695 COUNTY  
 DEPARTMENT PRIORITY REQUEST ...  
 LOCATION - NE 132ND ST NE 160TH  
 CIP PLANNING AREA - 006 NORTH  
 COUNCIL DISTRICT - 003

OPTION	PRIOR YRS EXPENDITURES	EXISTING BUDGET	1978 REQUEST	PROGRAM PROJECTION ***** 1979 1980
1. DESIGN, PRELIM ENGINEERING		17,000		
2. ACQUISITION OF RIGHT-OF-WAY		40,000		
3. CONSTRUCTION			74,000	
....ANNUAL PROJECT TOTAL		57,000	74,000	
....78-83 PROJECT COST	74,000			
....TOTAL PROJECT COST	131,000			
-----				
REVENUE SOURCES				
32140 (A) LEA M FORD GRANT		27,050	48,000	
<del>*****</del>		10,950	26,000	
30110 (A) BEG. UNENCUMBERED FUND BALANCE		19,950	26,000	
....ANNUAL REVENUE TOTAL		57,000	74,000	
....TOTAL REVENUE	131,000			
		( 131,000 - AVAILABLE		- FENCING

# Des Moines Way So. at S.W. Normandy Road

Description: Council District: No. 7  
 CIP Planning Area: West Central

Location: Intersection of Des Moines Way So. @ S.W. Normandy Road  
 Work Scope: Intersection type improvements as required (Channelization, Signal Phasing, and Pavement Markings).  
 Objective: Improve pedestrian safety and traffic flow.  
 Length: Intersection

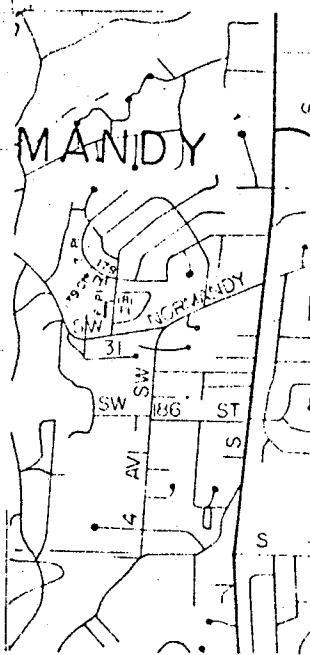

This project provides for Section 2, EE (58), Ordinance 3310.

Cost Data: Status:  
 Original Cost Estimate (1976) \$110,000 Programmed for design to start during 1977.

**Project Data:**

FUND	00000 3360	ARTERIAL HIGHWAY	AGENCY	70	RESPONSIBLE ORG	1695	COUNTY	
DEPT	0737	ROADS-COUNTY ROADS CONST			DEPARTMENT PRIORITY REQUEST		6	
FUNCTION	54100	ROAD & STREET CONSTRUCTION			LOCATION - INTERSECTION			
SERVICE	54157	SPECIALIZED PROJECTS			CIP PLANNING AREA - 004		WEST C	
PROGRAM	54177	DISCRETE PROJECTS			COUNCIL DISTRICT - 007			

OPTION	PRIOR YRS EXPENDITURES	EXISTING BUDGET	1978 REQUEST	PROGRAM PROJECTION 1979	PROGRAM PROJECTION 1980
1. DESIGN, PRELIM ENGINEERING		22,000			
3. CONSTRUCTION		88,000			
....ANNUAL PROJECT TOTAL		110,000			
....78-83 PROJECT COST					
....TOTAL PROJECT COST	110,000				
-----					
REVENUE SOURCES					
33141 (A) F A M ROAD GRANT		88,000			
37203 (A) CENTRAL-COUNTY-ROADS		22,000			
30110 (A) BEG. UNENCUMBERED FUND BALANCE		22,000			
....ANNUAL REVENUE TOTAL		110,000			
....TOTAL REVENUE	110,000				

( 110,000 - AVAILABLE - FENCING

**Description:**

Council District: No. 8  
CIP Planning Area: West Central

Location: Military Road South to Tukwila City Limits

Work Scope: Bring to current County standards through improvements such as grading, paving, install necessary drainage facilities and moderate type landscaping.

Length: 0.50 Mile

This project provides for Section 2 EE (53), Ordinance 3310.

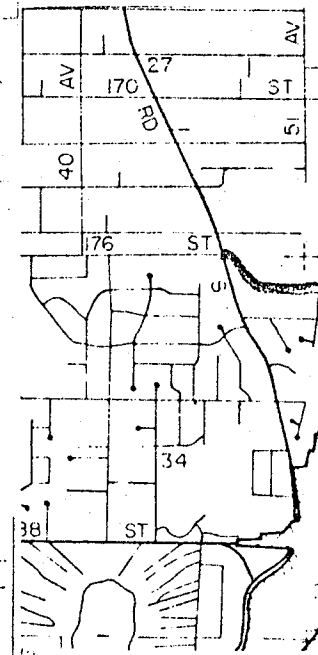

**Cost Data:**

Original Cost Estimate (1976)

\$282,000

**Status:**

Design start 1977.

**Project Data:**

FUND 00000 3360 ARTERIAL HIGHWAY  
DEPT 0737 ROADS-COUNTY ROADS CONST  
FUNCTION 54100 ROAD & STREET CONSTRUCTN  
SERVICE 54153 ARTERIAL-SECONDARY  
PROGRAM 54173 DISCRETE PROJECTS

DEPARTMENT PRIORITY REQUEST R  
LOCATION - MILITARY ROAD SO TO T  
CIP PLANNING AREA - 004 WEST C  
COUNCIL DISTRICT - 008

OPTION	PRIOR YRS EXPENDITURES	EXISTING BUDGET	1978 REQUEST	PROGRAM PROJECTION 1 ***** 1979 1980
1. DESIGN, PRELIM ENGINEERING		53,000		
3. CONSTRUCTION			95,000	
....ANNUAL PROJECT TOTAL		53,000	95,000	
....78-82 PROJECT COST	95,000			
....TOTAL PROJECT COST	148,000			
REVENUE SOURCES				
33141 (A) F A M ROAD GRANT		34,000	62,000	
30110 (A) BEG. UNENCUMBERED FUND BALANCE		19,000	33,000	
....ANNUAL REVENUE TOTAL		53,000	95,000	
....TOTAL REVENUE	148,000			
		( 148,000 - AVAILABLE		- PENDING

Description:

Council District: No. 6  
 CIP Planning Area: East Central

Location: East Lake Sammamish Road to Issaquah-Pine Lake Road

Work Scope: Construct major route providing access to Pine Lake Plateau. Construction to consist of County standard road section with open ditch drainage.

Objective: Upgrade facility to partial compliance with the 1990 Interim Transportation Plan via the reconstruction and inclusion of upgrade passing lane to augment two travel lanes, thereby, providing improved connection for traveling public between the Sammamish-Pine Lake Plateau and recreation/shopping areas in the Issaquah vicinity.

Length: 1.10 Mile This project provides for Section 2 EE (84)

Cost Data:

Original Cost Estimate (1970) \$669,138

Status:

Preliminary engineering and Plan Development starting mid-1977.

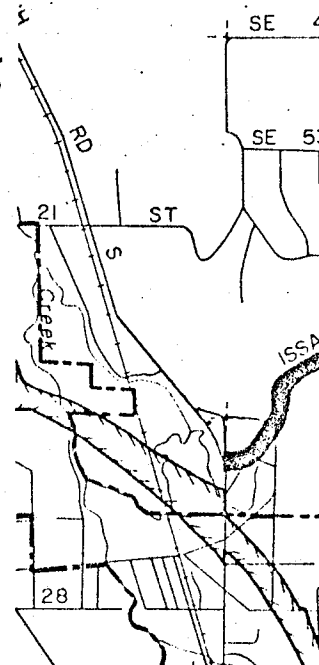

Project Data:

FUND 00000 3360 ARTERIAL HIGHWAY DEV.  
~~00000 3360 ARTERIAL HIGHWAY DEV.~~  
 DEPT 0737 ROADS-COUNTY ROADS CONST  
 FUNCTION 54100 ROAD & STREET CONSTRUCTION  
 SERVICE 54152 ARTERIAL COLLECTOR  
 PROGRAM 54172 DISCRETE PROJECTS

AGENCY 70 RESPONSIBLE ORG 1695 COUNTY  
 DEPARTMENT PRIORITY REQUEST  
 LOCATION - E LAKE SAMMAMISH RD  
 CIP PLANNING AREA - 011 EAST CENTRAL  
 COUNCIL DISTRICT - 006

OPTION	PRIOR YRS EXPENDITURES	EXISTING BUDGET	1978 REQUEST	PROGRAM PROJECTION ***** 1979	1980
1. DESIGN, PRELIM ENGINEERING		100,000			
2. ACQUISITION OF RIGHT-OF-WAY				115	
3. CONSTRUCTION					671
....ANNUAL PROJECT TOTAL		100,000		115	671
....78-P2 PROJECT COST	786,000				
....TOTAL PROJECT COST	886,000				
REVENUE SOURCES					
30142 (A) F A S ROAD GRANT		65,000		75	436
<del>30142 (A) F A S ROAD GRANT</del>		35,000		40	235
30110 (A) BEG. UNENCUMBERED FUND BALANCE		35,000		40	235
....ANNUAL REVENUE TOTAL	56,764	100,000		115	671
....TOTAL REVENUE	942,764	1,000,000		115	671
		1,000,000 - AVAILABLE			- PENDING